

SAFETY COVER

INSTALLATION & MAINTENANCE INSTRUCTIONS

Coverttech strongly recommends that experienced professionals install the Safety Cover

Safety Covers are made according to the provided measurements. When requested, Coverttech will add special design features to address the location of ladders, slides, rocks, spas, and other obstructions. We may also suggest upgrades for pools with rough areas or features that are difficult to anchor due to space limitations.

RECTANGULAR & FORM-FIT COVER INSTALLATION

1. Remove all ladders and handrails. The cover must have pre-purchased factory-installed padding on any rough corners or sharp edges. Excessive wear due to non-padded areas is excluded from the warranty.
2. Measure the pool and the cover to determine the overlap of the cover. Take the difference on width and length and divide it by two. The overlap could vary from 10 to 18 inches.
3. Place cover over the pool with the Anti-rub strips on the bottom (do not snag or damage the cover). The warning label should be facing up. Adjust to the overlap determined in Step #2, and use weight to hold the cover in place (buckets of water or bags of sand).
4. Locate and mark anchor position for straps 1, 2, 3 and 4 (figure 1). Brass anchors are placed approximately 18" from pool cover edge (figure 3). On decks less than 36" wide or in corner or step areas, it may be necessary to place anchors beyond the deck area by using Garden Anchors if included. The SDM (Short Deck Mounting) system is also an option, if requested, when decks are less than 36" wide.
5. Install anchors and attach the springs for straps number 1, 2, 3 and 4 (figure 1) See page 2 for anchor and spring installation guide.
6. Place the springs for straps number 1, 2, 3 and 4 on the anchors using the installation rod tool.
7. Locate and install anchors and attach springs for straps number 5, 6, 7 and 8.
8. Continue with the anchor points for the rest of the cover. With all anchors and springs installed, recheck all the anchors and straps to make sure they are secured and adjusted with equal tension.
9. After completing the initial installation of the first 8 anchors, install remaining anchors working from center of the cover to the ends. Remember to alternate sides and to attach and secure each spring as each anchor is installed.
10. Once all anchors and springs are in place, adjust the tension equally on all springs, making sure overlap is equal all the way around pool and that cover lies perfectly (ensure that each spring is compressed between 50% and 70% of total).
11. Special instructions for Solid Covers: Adjust tension on straps and springs to ensure proper water drainage.

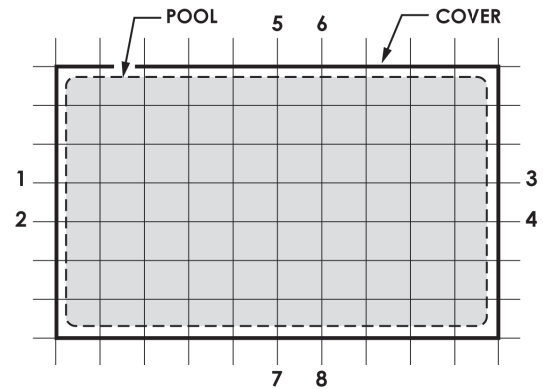

(Figure 1)

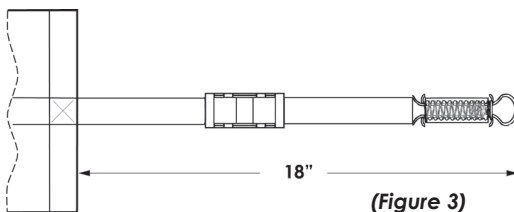
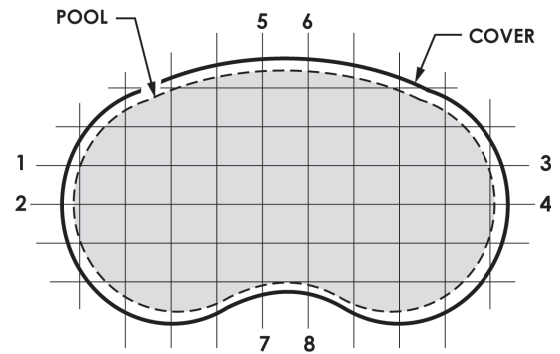

(Figure 3)

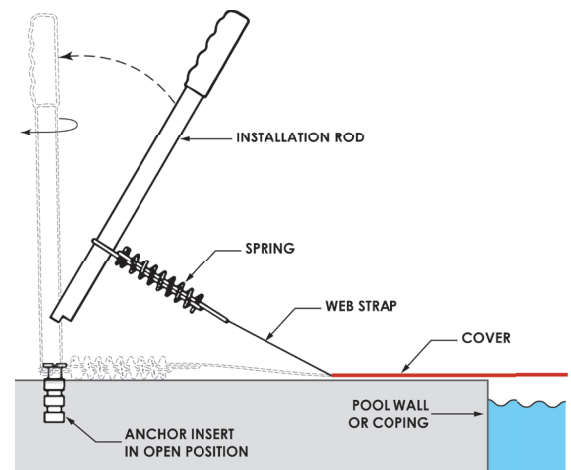

(Figure 2)



CONCRETE ANCHOR INSTALLATION

1. Drill 2-1/4" inches into the deck using a rotary hammer drill with a 3/4" inch masonry bit.
2. Vacuum or flush out the concrete dust at the bottom of the hole.
3. Remove the anchor insert from the anchor. Place the brass anchor into the hole and use the tamper tool to tamp it down carefully until flush with the deck.
4. Screw the anchor insert into all anchors using the hex key, with around 1/2" of the anchor insert above the deck to secure the spring.

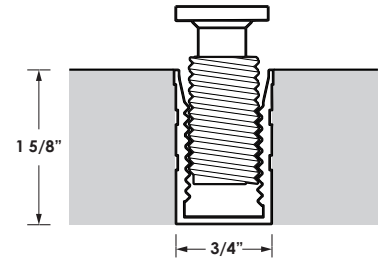

WOOD ANCHOR INSTALLATION

1. Install wood deck anchor by drilling a 1-1/2" diameter hole to a depth of 1/8" with a wing bit.
2. Drill a 3/4" diameter hole in the center of the wing bit hole to a final depth of 1-1/4".
3. Vacuum dust and chips.
4. Insert anchor casing in hole flush with the deck surface and attach with (4) brass screws provided.
5. Add brass collars and screw the anchor insert with the hex key, with around 1/2" of the anchor insert above the deck to secure the spring.

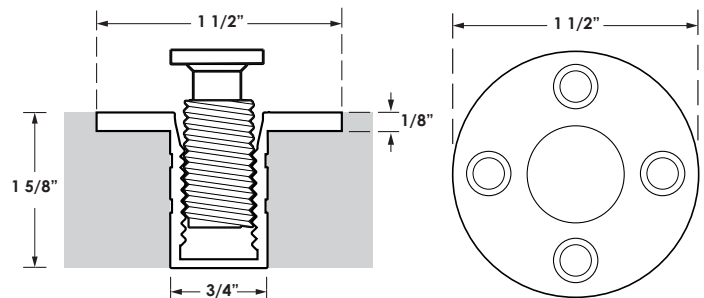

GARDEN ANCHOR INSTALLATION

Anchoring Into Lawns, Planters or Soil

- Use Covertech heavy duty 18" Aluminum Garden Anchor.
- To install, locate anchor position and using a block of wood and mallet, tap the Garden Anchor into place with the insert removed, then attach springs.

Note: Aluminum Garden Anchor do not provide the same degree of safety as a standard anchor or paver tube and should not be used for more than 20% of the anchoring points around a pool. Aluminum Garden Anchor should also never be placed at opposite ends of the same strap.

PAVERS ANCHOR INSTALLATION

Anchoring Into Brick or Stone Pavers using a Paver Tube 9" or 15".

- Paver Tube comes with anchor pre-installed flush to top of paver tube.
- Before drilling into masonry, first try drilling a test piece.
- Drill a 7/8" diameter hole into the deck to a depth of 9-1/4" or 15-1/4" (depending on paver's type).
- Use a block of wood and mallet to tap the Paver Tube into the hole unit until it's flush with the deck surface. Then remove the anchor screw, lubricate it and screw it into the body of the anchor tube until only the un-threaded portion is showing.

LACING SPRING TO STRAP

- Thread the strap through the spring and back through the buckle on the strap following the steps on the illustration.
- Attach the springs so that the end of the spring is approximately 18" from the edge of the cover. The distance should be adjusted as required.

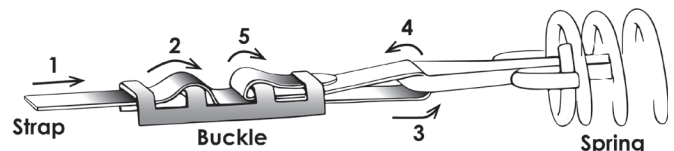

RAISED WALLS & WATER FEATURES INSTALLATION

CABLE ASSEMBLY KIT INCLUDES:

- Stainless Steel Cable – Length equals distance of wall plus extra feet
- (4) Stainless Steel cable clamps
- (2) Thimbles
- (2) Brass anchors
- Waterfall Anchors.

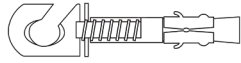

STEP 1:

- Use raised wall area as starting point for installation.
- Install (2") brass anchor at each end of the raised wall. These anchors to be used to attach the cable.

STEP 2:

- Locate Cable Waterfall Anchor positions.
- To ensure cover is level, install wall anchors at the same level as the deck.
- Waterfall Anchors should be installed every 3' on straight walls and every 18" on radius walls.

STEP 3:

- Drill holes using 3/8" drill bit. Hole depth into the masonry wall should be 2-1/2".
- The hole should be 1/4" deeper than anchor shaft.
- Vacuum hole of any debris.

STEP 4:

- Unscrew the Waterfall Anchor head from the expansion casing, and gently tap the expansion sleeve fully into the hole.

STEP 5:

- Thread the Waterfall Anchor head with washer fully into the expansion casing until contact is made with the wall.

STEP 6:

- Using a screwdriver for leverage, turn the Waterfall Anchor head in a clockwise direction to set the anchor.
- The cable slot should face upward.
- Continue installing remaining Waterfall Anchors.

STEP 7: INSTALL CABLE

- Create a loop on one end of the cable using one Thimble and two Cable Clamps.
- Hook the looped end of the cable on one of the Extra Long (2") brass anchors that was installed in step 1 above and run cable in the Waterfall Anchors to opposite end of raised wall.
- Create a loop to the other end of the cable using the remaining Thimble and Cable Clamps.
- Hook the looped end of the loosened cable to the second Extra Long (2") brass anchor that was installed in Step 1.
- Pull the cable and lock it with the Cable Clamps so cable is tight.
- Note: proper installation requires that the gap between cover and wall must not exceed 4". If a gap larger than 4" exists, you may need to add more waterfall anchors to pull cover closer to the wall and/or tighten cable to reduce any slack.

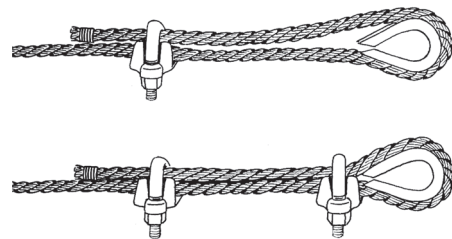

STEP 8:

- Position the cover on the pool to begin installation.
- The cover should be attached to the cable area first.
- Fasten snap hooks on the underside of the cover to the cable.

STEP 9:

- Mark and install anchor locations on the opposite side of the pool from the raised wall.
- Install those cross straps and ensure they are straight and tight.
- Continue installing cover using Custom Cover installation instructions on Page 1.

SDM (SHORT DECK MOUNT) SYSTEM

Covertch offers an option of using Short Deck Installation System (SDM) to install covers with a deck as small as 14" wide that make it impossible to install the anchors in the standard locations, or use of short springs and lawn tubes. The SDM system must be ordered with the cover and cannot be a retrofit solution.

- Installing covers with SDM involves just a few extra steps over normal installation. Before attaching a spring to one of the cover straps, thread the strap through one of the D-Rings supplied with the cover, then attach the strap to the spring as you would a normal installation. Adjust the strap to provide the desired tension.
- Next, attach the round end of the spring to the strap that is sewn onto the top of the cover approximately 18" back from the edge.
- The final step is to install the D-Ring to the deck anchor using the included cover installation tool. Use the same technique that you use to install a spring onto an anchor.
- If tension adjustment is needed, uninstall the D-Ring from the anchor and adjust the strap as you would in regular spring installation.

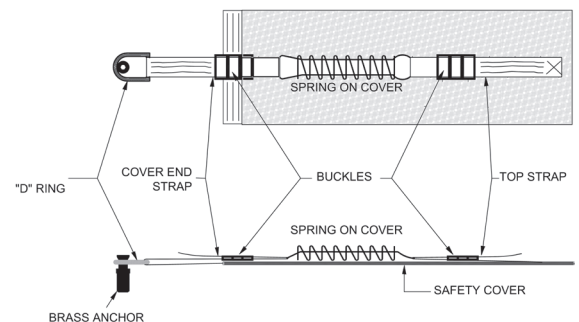

SAFETY COVER

CARE & MAINTENANCE INSTRUCTIONS

- The cover must be installed taut. Loose-fitting covers can cause excessive abrasion.
- Upon installing the springs, ensure that they are compressed to about 60% as they will relax within several weeks.
- We recommend re-tightening the cover 2 to 3 weeks after the initial installation.
- Inspect the springs periodically to make certain they are compressed about halfway.
- It is advisable to maintain the proper chemical levels in the pool year round. Additional algacide should be added to the pool when the air temperature is consistently 16°C (60°F).
- Water level should not exceed 18" from the top of the pool during the snow season to help support the weight. Failure to do so will void the warranty.
- When installing or removing the cover, Do not drag the cover over any abrasive surface and be careful not to catch the cover material on the springs or anchors.
- Covertech is not responsible for damage if the pool edging or deck is sharp or abrasive and the cover was not ordered with Covertech installed padding.
- Flush out the Anchor casings with a hose two to three times per year. Simply remove the anchor screw to flush the casing and spray the anchor screw with silicone prior to screwing it flush when the cover is removed.
- Prior to removal, clean The cover with a hose, for ease of handling, fold the cover accordion-style and store it in the provided bag. Hang the bag off the floor for drainage to protect it from animal or rodent infestation.
- Solid covers with mesh drain panels require adjustment after installation to ensure proper drainage. Flood the cover with water and observe if standing water forms puddles that do not drain. If this occurs, loosen the strap on either side of the drain and tighten the straps in the areas with standing water.
- Read the warranty carefully as to its conditions and make sure to register the warranty Online on our website www.covertechind.com
- Our safety covers are built to meet or exceed related safety regulation. However, it is the consumer responsibility to assure safety standards are maintained.

AT NO TIME SHOULD ANYONE PURPOSELY WALK ON THE SAFETY COVER

**Covertech Industries
Limited will not be held
responsible for improperly
installed safety covers.**

**Safety covers should be
installed by a trained
professional**



WARNING!

AVOID DROWNING RISK

- ☐ STAY OFF COVER.
- ☐ SUPERVISE CHILDREN.
- ☐ REMOVE COVER COMPLETELY BEFORE USE.
- ☐ IMPROPERLY SECURED COVER ARE HAZARD.
- ☐ FAILURE TO FOLLOW ALL INSTRUCTIONS MAY RESULT IN INJURY OR DROWNING.
- ☐ MEETS OR EXCEEDS STANDARD PERFORMANCE SPECIFICATION SET FORTH IN ASTM: F1346-91 FOR MANUAL SAFETY COVER.
- ☐ INSPECT COVER ANNUALLY FOR DAMAGE.
- ☐ DO NOT REMOVE THE WARNING LABEL.

